

## Retreat Schedule...

Friday April 15	4pm - 6pm 6pm - 8pm 8pm - 9pm	Arrive at the Grand Fir Lodge Dinner on your own (1) Wine Tasting
Saturday April 16	8am - 9am 9am - Noon Noon - 1pm 1pm - 4pm 4pm - 6pm 6pm - 8pm	Group Breakfast (2) Knitting Class Group Lunch (2) Afternoon Activity (3) Book Discussion Dinner on your own (1)
Sunday April 17	8am - 9am 9am - Noon Noon - 1pm 1pm - 4pm 4pm - 6pm 6pm - 8pm	Group Breakfast (2) Knitting Class Group Lunch (2) Afternoon Activity (3) Wine Tasting Dinner on your own (1)
Monday April 18	8am - 9am 11am	Group Breakfast (2) Check-out

(1) Prepare your own Dinner in Grand Fir's gourmet kitchen or go out to Dinner at Portals at the Suncadia Lodge, Swiftwater Cellars Winery or other area Restaurants. Snacks will also be provided.

(2) Group Meals are included in the cost of the retreat.

(3) Activity Ideas: Walks, Hikes, Bike Riding, Winery Tour, Swim & Fitness Center \*, Spa Visit, Visit Roslyn, or just relax at the Grand Fir Lodge.  
(\* S&FC daily use fee of \$7 may be charged)

## Floor Plan of the Grand Fir Lodge...

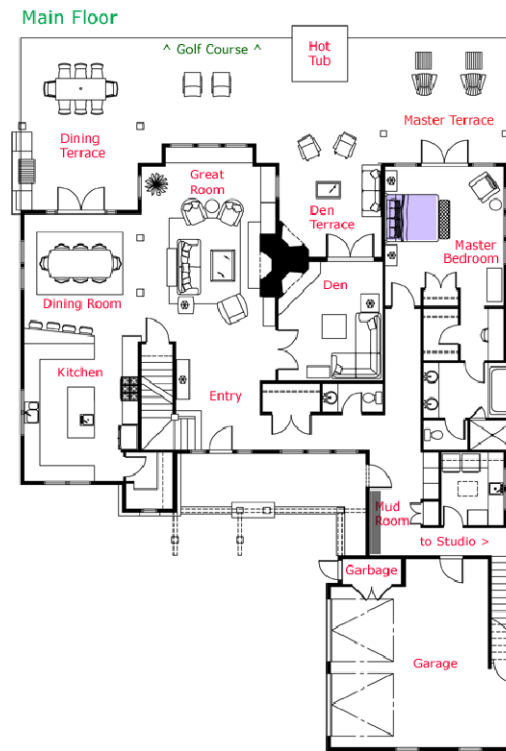

### Upper Floors

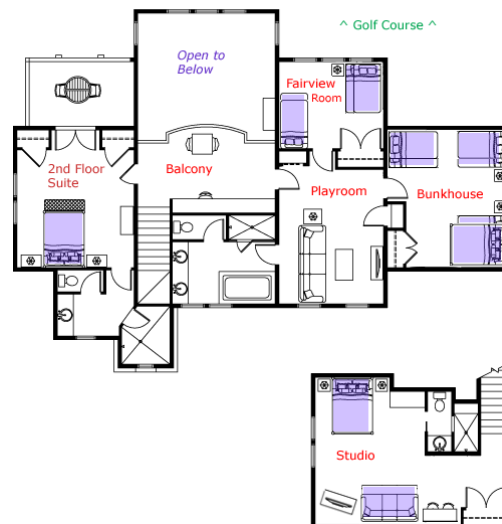

Presents:

# a Retreat in Suncadia



This is an example brochure to show you what can be produced free of charge for your own Retreat at the Grand Fir Lodge in Suncadia. Please contact Pat Gilbrough at 206-683-6487 or [info@grandfir lodge.com](mailto:info@grandfir lodge.com) for Lodging/Retreat booking information

April 15th - 18th  
at the Grand Fir Lodge in Suncadia



## Retreat Pricing...

Room / Bed	Price
Bunkhouse Twin 1	\$355
Bunkhouse Trundle 1	\$355
Bunkhouse Twin 2	\$355
Bunkhouse Trundle 2	\$355
Bunkhouse Queen	\$395
Bunkhouse Trundle 3	\$355
Fairway Room Twin	\$355
Fairway Room Trundle	\$355
Fairway Room Bottom Bunk	\$355
Fairway Room Top Bunk	\$355
Studio Daybed	\$355
Studio Trundle	\$355
Studio Queen	\$395
2nd Floor Suite Queen	\$475
Master Bedroom King	\$545

To view current availability for the retreat - please visit:  
[www.grandfir lodge.com / retreats / example](http://www.grandfir lodge.com/retreats/example)  
or call Brown Bird at 206-683-6487

[www.grandfir lodge.com](http://www.grandfir lodge.com)

[www.grandfir lodge.com](http://www.grandfir lodge.com)

## About Suncadia...

### Size

Suncadia Resort is a 6,400 acre luxury all season Washington State mountain resort, adjoining the Cle Elum River corridor with 1,200 acres of pristine forest, adjacent to the 2.2 million acre Wenatchee National Forest.

### Location

Suncadia Resort, located 80 miles east of Seattle, offers a mountain resort experience on the sunny eastern slopes of the Cascade Mountains.



### Suncadia Center

The Lodge at Suncadia, a full-service 253 unit luxury condominium lodge hotel and conference center overlooking the Cle Elum River.

- Casual and Fine Dining:
  - Portals Restaurant
  - 56 Degrees Bar
  - Gas Lamp Grille
  - Hoist House at Swiftwater Winery
  - Chill & Grill at the outdoor pool (Summer)
- Glade Spring Spa, world-class destination spa includes 14 treatment rooms and outdoor salt soaks
- Swim & Fitness Center, complete facility featuring indoor/ outdoor pools, fitness machines and indoor waterslides

### Community

With 3200 residential units in the Suncadia master plan, approximately 1000 of those units are owned by members of the Suncadia community. These units include building lots, condominiums and completed homes.

### Golf Courses

Washington State's best mountain golf with three championship courses:

- Prospector, designed by Palmer Course Design
- Rope Rider, a family-friendly course by Jacobsen Hardy Golf Course Design (planned completion 2011)
- Tumble Creek, a private course designed by Tom Doak

### Swiftwater Cellars Winery

The newest addition to the Suncadia Resort opened Sept 2010. A 40,000 SF facility with a full winery operation, tasting room, retail shop, and the Hoist House Restaurant.

## About the Retreat...



BirdCone is a fictitious business used to show you an example of what can be put together for you to host a weekend retreat at the Grand Fir Lodge in Suncadia. This area of the brochure is used to describe the weekend retreat to your potential guests. There are 15 individual beds at the Grand Fir that can be "sold" individually or however you would like to make your offering for your special weekend. The creation of this custom brochure and optional associated registration web page is produced for no additional charge as a benefit of using the Grand Fir Lodge for your event. The prices per bed are established and collected by you the host. There is a fixed lodging cost per guest by the owner of the Grand Fir Lodge.

This is the area of the brochure where a description of your retreat would go. If you have any special guests, perhaps a picture of them and an explanation of what they will cover. You can have a retreat schedule as shown on the other page of this brochure example or don't include it in the brochure - it is completely up to you the host how you want to present the retreat offering.



## About the Grand Fir Lodge...

The **Grand Fir Lodge** was built for a relaxing escape from the stresses of everyday life. The setting is on the 13th hole of the award winning Prospector Golf Course in the heart of Suncadia. The mountain lodge style home features large fir exposed trusses with 4000 square feet of living space including 5 bedrooms, 3 fireplaces, a 7 person hot tub, a large gourmet kitchen, a Wii gaming system with lots of games, ping pong, air hockey, a fully stocked board game, toys and puzzle closet, a DVD movie library, a state-of-the-art home automation system, over 20 pieces of patio furniture, the list goes on. All guests of the Grand Fir Lodge have access to Suncadia's Swim & Fitness Center with indoor pool and water slides, expansive summer outdoor pool, sauna, steam room, exercise classes, fitness equipment and free weights.

